

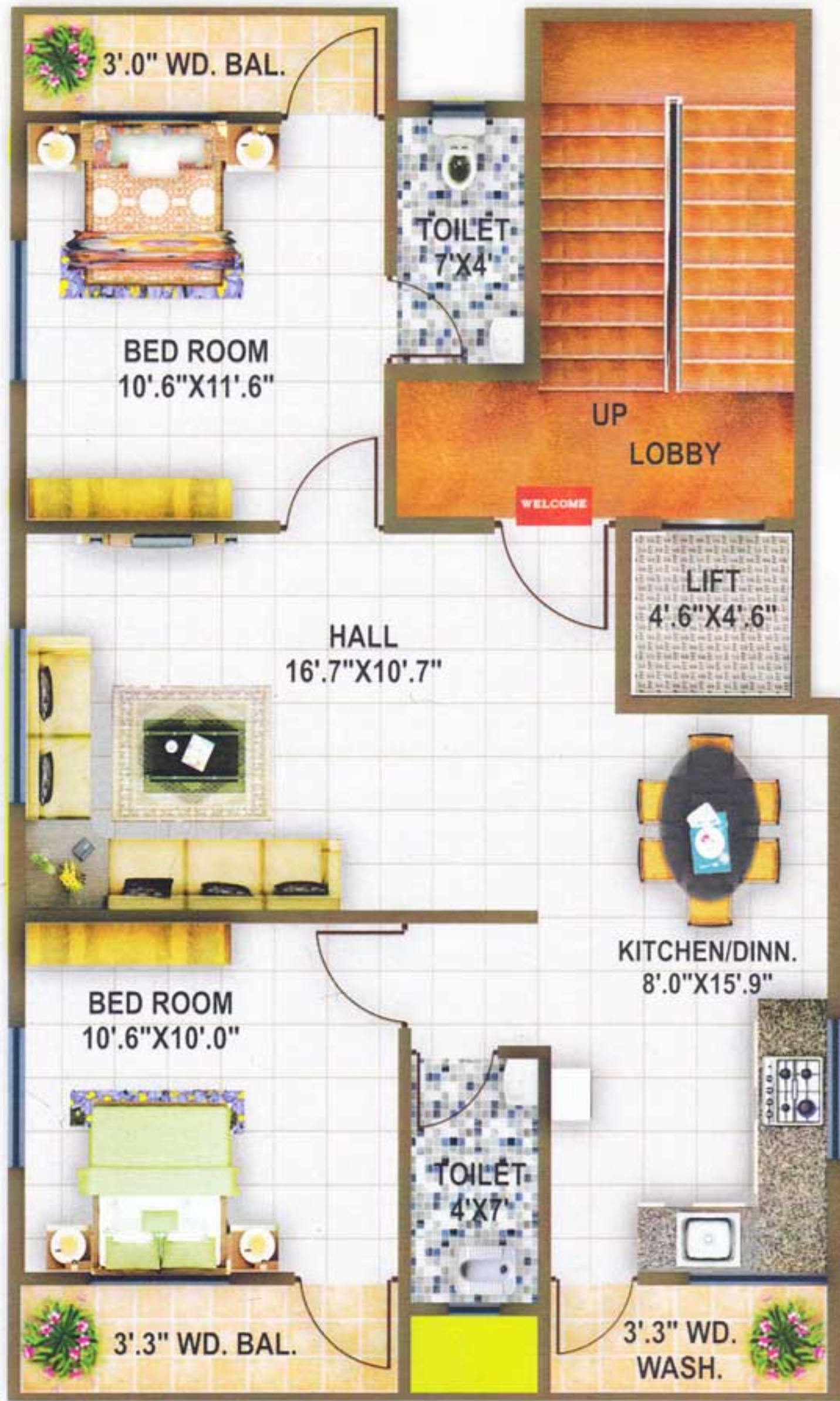

Mahalaxmi
Lotus





FIRST, SECOND & THIRD FLOOR PLAN
 (S.B./UP : 945 sq.ft.)



GROUND FLOOR PLAN

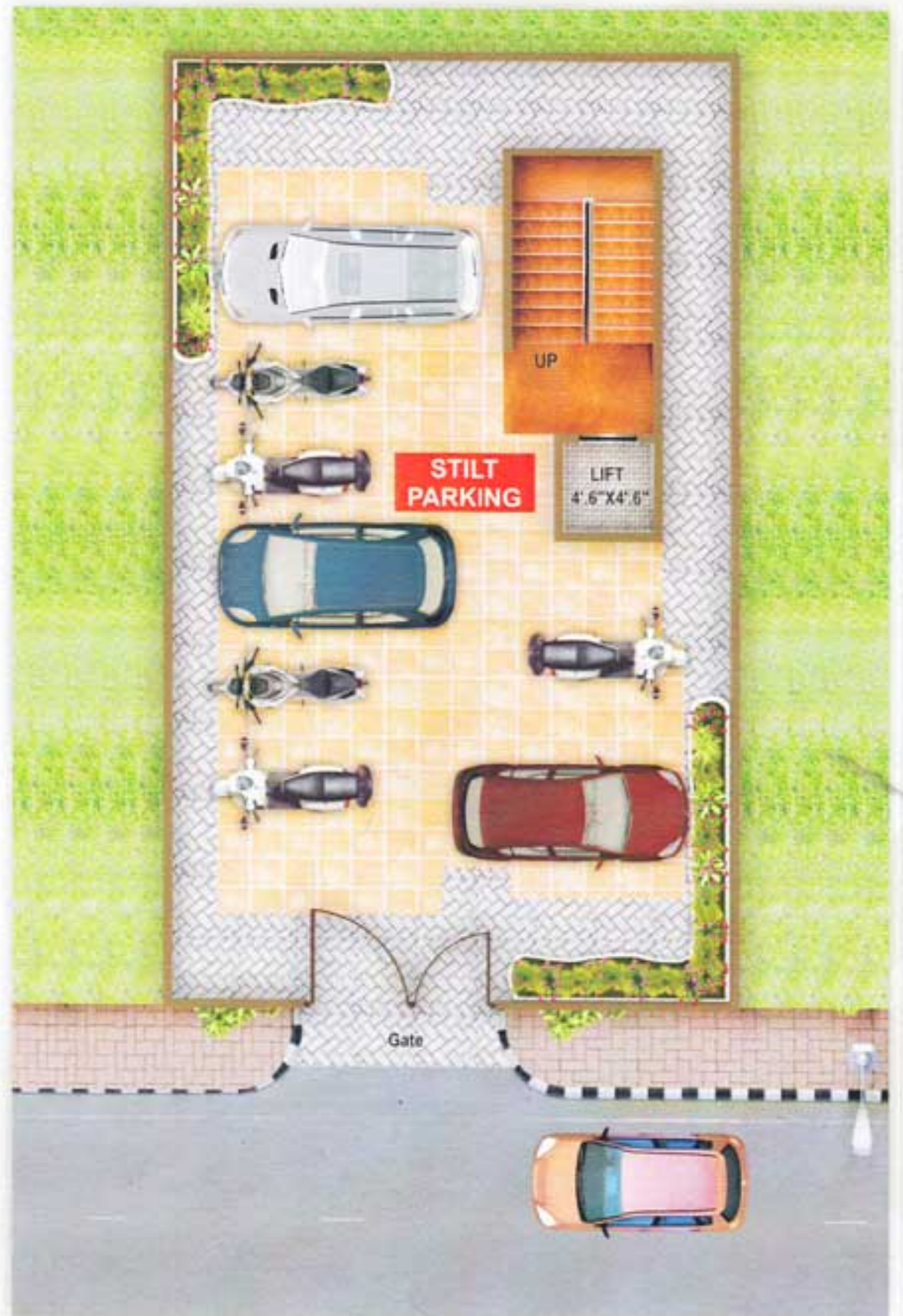

General Specification

Structure :

R.C.C. Framed Structure with Earthquake Proof Structure.

Super Structure :

Outer 0.15 MT THK. Inner 0.115 MT. THK.

Plaster :

Outer Side Sand Faced Plaster & Inner Funty Plaster.

Door :

Front Door in Teak Wood Frame & Shutter or Bajaj secure door,
All Internal Door Frame in R.C.C. & Flush Door Shutter.

Window :

Aluminium, Glazed/Sliding Window Powder Coated with M.S. Grill.

Flooring :

Vetrified Tiles Flooring in All Rooms.

Kitchen:

Modular Kitchen Grenite top with SS sink. Glazed Tiles
Above Platform, Aqua Guard Point in Kitchen.

Electrification :

Single Phase electric supply. Concealed electric wiring
with equipped points, Fire Resistant wires of ISI mark,
Moduler switches, one Tv point in Living area.

Lift :

1 No. Spacious Lift will be Provided.

POP :

P.O.P. in Hall & Master Bedroom.

Plumbing Fitting :

All Fitting will be Concealed with standard
Tabs Fitting (Jaquar or Parryware). ISI mark full
CPVC, UPVC, SWR Pipe Fitting

Paint :

O.B.D. Paint with Putty in all Rooms &
Water Proof Cement Paint to Exterior Walls.

Water Supply :

24 hrs. Water Supply from overhead tank.

PURCHASER HAS TO PAY THE FOLLOWING CHARGES SEPARATELY

- A) M.S.E.B. Meter Deposits & Water Meter Charges Extra.
- B) Registration, Stamp Duty & Documentation Charges Extra.
- C) Sales tax, Service tax and LBT as per applicable

Special Information

- A) Extra work other than specification & any other Changes will be charged separately.
- B) No External/Internal Modification shall be allowed to affect the External Elevation.

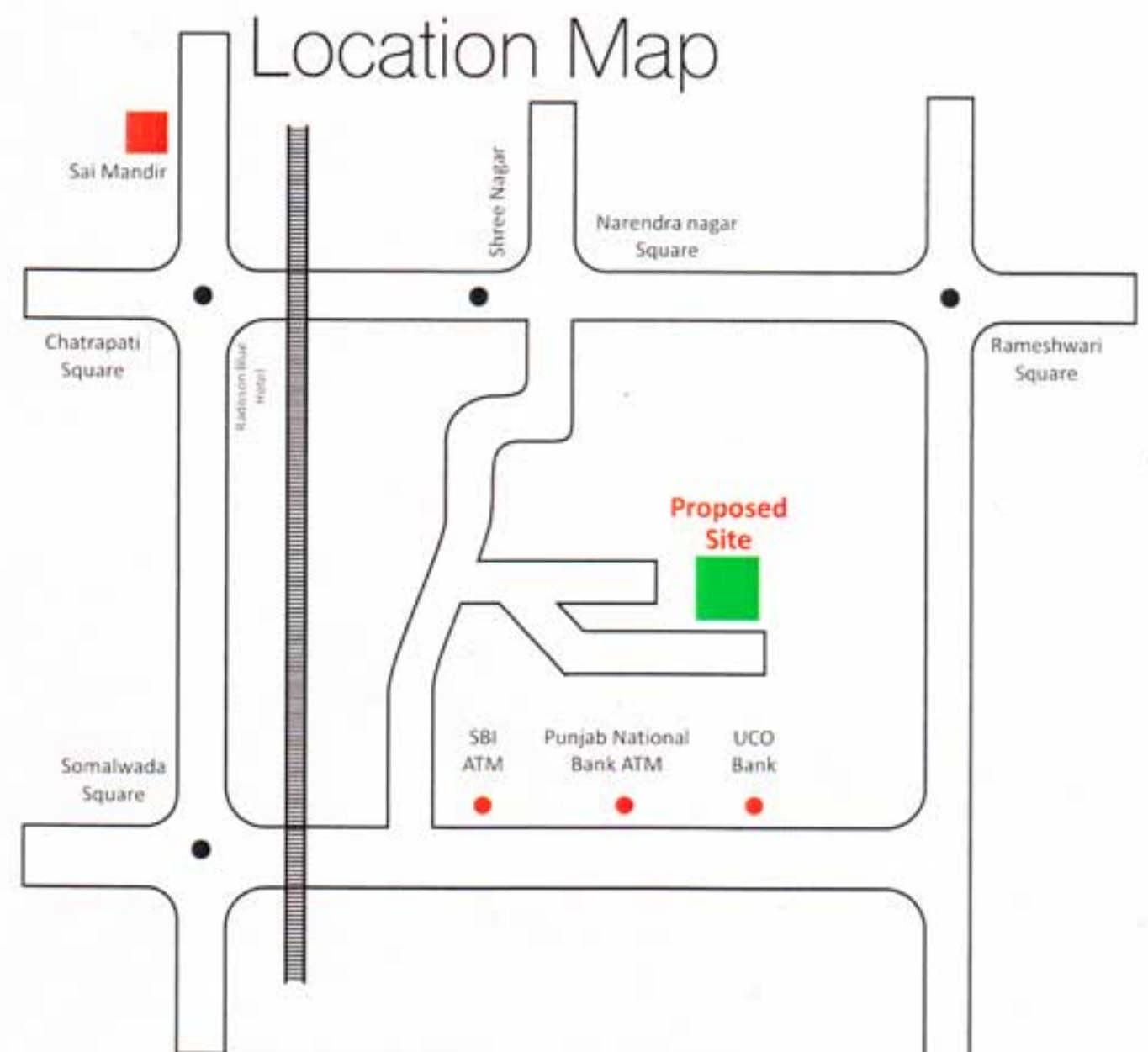

SITE ADDRESS : 35, SANTAJI SOCIETY,
NARENDRA NAGAR, NAGPUR

A Project By



: Promotor :
Mr. AMIT MARAWAR

FOR BOOKING CONTACT : 9823389955

B-23, Shree Ganesh Apartment, Kotwal Nagar, Khamla Sq., Ring Road, Nagpur-22. Ph. : 0712-3273702

Email : mahalaxmirealities@gmail.com Website : www.mahalaxmirealities.com

Legal Advisor
Adv. Ram Joshi

Planning Consultant
Nandkishor & Associates
Ph. No. 9665061078, 2783040

Structure Consultant
P. Y. Ghushé